

# DURA-BILT

Series  
.75

# APARTMENT COMPACTORS

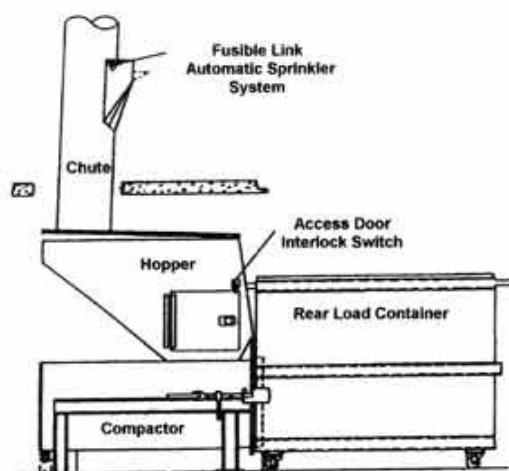
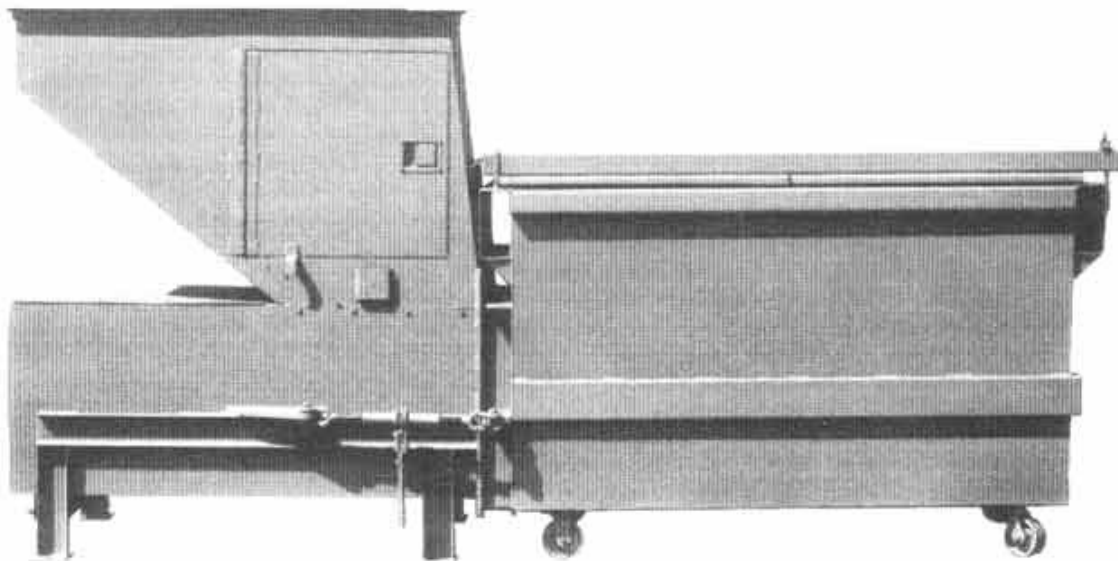

## .75 Cubic Yard Capacity

**IDS**

**Industrial Disposal Supply**

San Antonio  
P.O. Box 8175  
78208  
210/227-3441  
Fax 210/227-4424

Houston  
P.O. Box 8623  
77249  
713/692-7289  
Fax 713/692-7996

Plano (Dallas)  
P.O. Box 860707  
75086  
800/452-1423  
Fax 972/424-7203

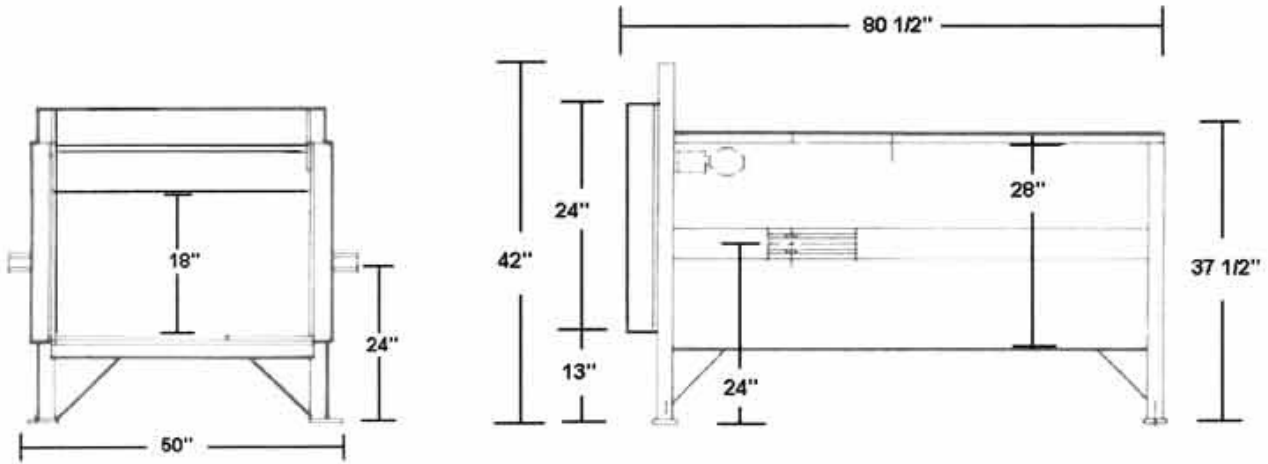

### Specifications

Charge Box Capacity		
(Mfrs. Rating)	.75 cu yds	.573m <sup>3</sup>
(NSWMA Rating)	.70 cu yds	.535m <sup>3</sup>
Clear Top Opening	29.5"L x 37"W	749.3mm x 939.8mm

### Performance Characteristics

Cycle Time	45 s	45 s
Total Normal Force	18,900 lbs	84kN
Total Maximum Force	22,600 lbs	101kN
Normal Ram Face Pressure	17.5 psi	121kPa
Maximum Ram Face Pressure	21.1 psi	146kPa
Ram Penetration	5"	127mm

### Electrical Equipment

Electrical Motor		
3/60-208-230/460	3 HP	2.2kW
Electrical Control Voltage	120 VAC	120 VAC
UL Label Panel Box –		
NEMA Type		
All Circuits Fused		
Standard Controls: Keylock Start / Mushroom Stop / Reverse		
Connected to 13' (3962mm) Sealite		

### Hydraulic Equipment

Hydraulic Pump	5 gpm	15.1 liter / min
Normal Pressure	1500 psi	10.3 mPa
Maximum Pressure	1800 psi	12.4 mPa
Hydraulic Cylinder – Bore	4"	101mm
Weight	2,200 lbs	998kg

Specifications subject to change without notice.



Innovative  
Systems for  
Waste Material Handling

### Optional Equipment

- Fully Enclosed Dog House with Door
- Side or Rear Opening Thru-Wall-Chute with Security Door
- 'Trashmizer' Pressure Gauge
- Full Container Light
- Automatic Cycling
- Extra Length Hoses (if required)
- Oil Immersion Heater
- Deodorizer System
- Electric Eye or Sonic Sensor for Chute Loading
- Containers – Front or Rear Load  
2 – 8 yard Capacity

This equipment conforms to all applicable ANSI Z245.1 Safety Standards.

Pictures in this brochure are illustrative only. Products must be installed in conformity with ANSI Z245.1 as well as any applicable codes and regulations. Products must be used with safe practices and in accordance with said regulations and standards.

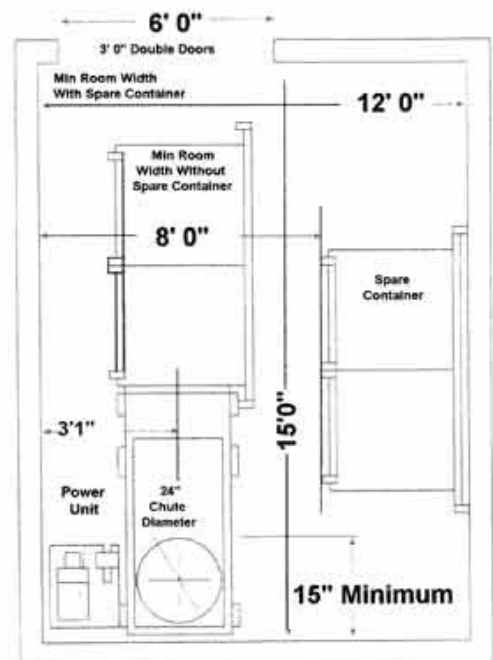

# IDS .75 Container

## Specifications

### Front Load

Overall Length .....	84"
Overall Width .....	44"
Overall Height.....	54"
Capacity .....	2 yd
Weight .....	758 lbs

### Construction:

Sides .....	12 gauge
Floor .....	12 gauge
Lids.....	12 gauge
Pockets .....	3/16 gauge

Swivel Casters (2) .....	8" Polyurethane/Steel
Rigid Casters (2) .....	8" Polyurethane/Steel

Hook-up .....

Ratchet, Clevis & 3/4" Lug

The IDS.75 Container easily connects to the IDS Apartment Compactor as shown.

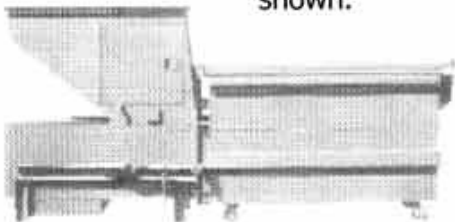

**IDS**  
**Industrial Disposal Supply**

San Antonio  
P O Box 8175  
78208  
210-227-3441

Houston  
P O Box 8623  
77249  
713-692-7289

Plano (Dallas)  
P O Box 860707  
75086  
800-452-1423

# IDS .75 Container

DRAWING NOT  
TO SCALE

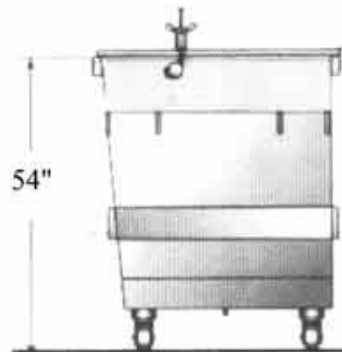
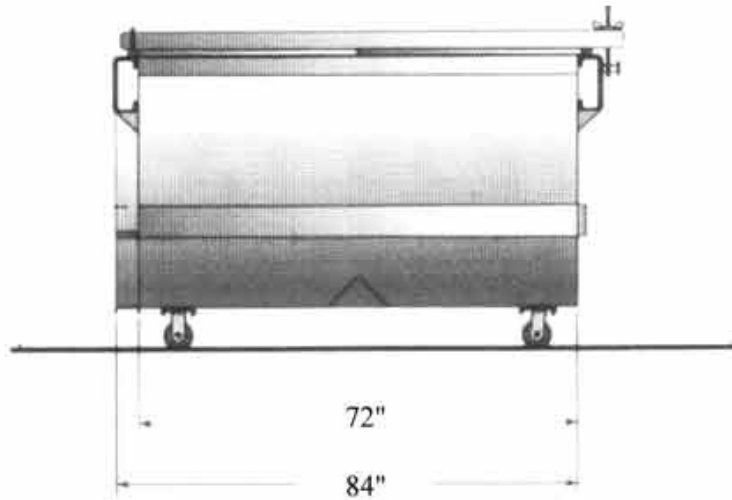
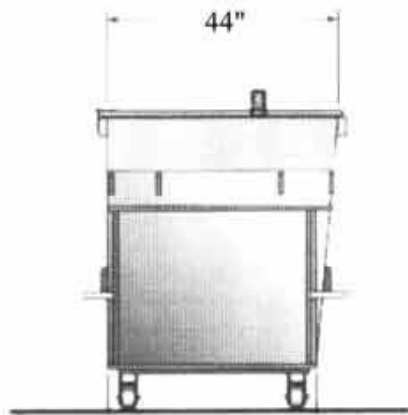

**IDS**  
Industrial Disposal Supply

San Antonio  
P O Box 8175  
78208  
210-227-3441

Houston  
P O Box 8623  
77249  
713-692-7289

Plano (Dallas)  
P O Box 860707  
75086  
800-452-1423